

## LED Wall Dimmer Switch -

Single Zone Glass Front Controller for RGB Colour Changing lighting



Part number LW-RGB-T



### 1. Technical Specs:

- Input Voltage: DC12V-24V
- Load Current: 4A×3CH Max 12A
- Grey Scale Level: 4096×4096×4096
- Max Output Power: 144W/288W(12V/24V)

- Working Temperature: -20°C~60°C
- Dimensions: L86×W86×H36(mm)
- Weight(N.W.): 162g

### 2. Installation Instruction:

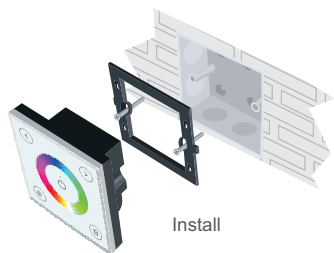

Install

— 5 —

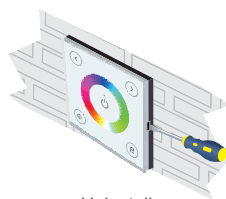

Uninstall

### 3. Key Functions:

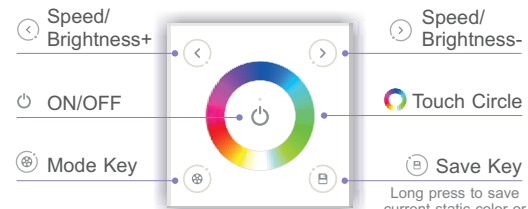

Long press to save current static color or changing effect.

\* Long press to turn on/off the buzzer.

The Changing Mode (Press to Switch):

- A. Static Red    B. Static Green    C. Static Blue    D. Static Yellow    E. Static Purple    F. Static Cyan
- G. Static White    H. RGB Skipping    I. 7 Colors Skipping    J. RGB Smooth    K. 7 Colors Smooth

### 5. Wiring Diagram:

Example 1: Connect with 12V Strip. Max 144W(12V)

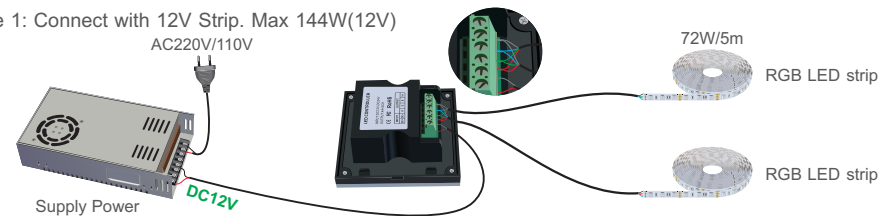

Example 2: Connect with 24V Strip. Max 288W(24V)

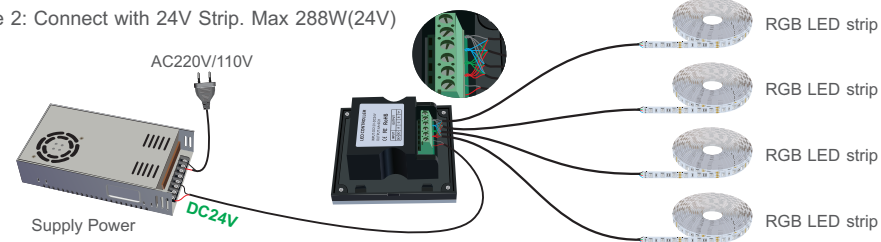

### 4. Green Block:

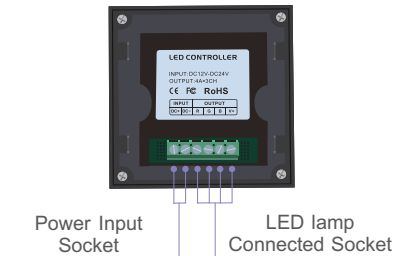

— 6 —