

A型

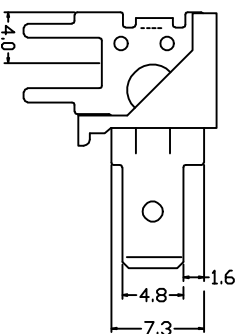

B型

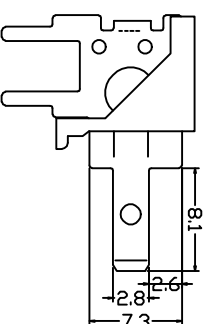

C型

250V 12A  
 Poles: (2-25P)  
 Pitch: 5.08mm (.200") 7.62mm (.300")

Materials  
 Housing: PC  
 Solder Pin: Brass, Tin Plated

序号/revno. 更改记录/revision record 签名/signature 日期/date

设计/modified by	绘图/drawing by	审核/checked by	批准/approved by	公差/General Tolerance
 新莱亚电子 XINLEIYA ELECTRONIC CO., LTD	图名/title	文件编号/file no.	页序/page	x. ±0.2 x.° ±2°
	XY256R-A/B/C			x. ±0.1 .x° ±1°
				.xx ±0.05 .xx° ±0.5°
				.xxx ±0.01
备注/remark				单位/unit(s): 厘米