



## 1310nm pulse laser

### Features

- Multiple Quantum Well (MQW) laser
- High output power
- Pulse width (PW) =10μs, Duty=1%



### Absolute Maximum Ratings (Tc=25°C .unless otherwise specified)

Parameter	Symbol	Value	Unit
Pulsed Forward Current	I <sub>FP</sub>	1.2	A
Reverse Voltage	VR	2.0	V
Operating Case Temperature	T <sub>c</sub>	-20 ~ +60	°C
Storage Temperature	T <sub>stg</sub>	-40 ~ +85	°C
Soldering Temperature/Time	-	260/10	°C/S
Relative Humidity (noncondensing)	RH	85	%

## Optical & electrical characteristics (Tc=25°C)

Parameter	Symbol	Min	Typ.	Max.	Unit	Test Conditions
Forward Voltage	$V_{FP}$			4.0	V	IFP ≤ 1200mA, PW=10us.Duty=1%
Threshold Current	Ith		45	75	mA	
Optical Output Power From Fiber	Pt	250	-	-	mW	@1310nm
		180	-	-		@1550nm
		100	-	-		@1625nm
		100	-	-		@1650nm
						IFP≤1200mA, PW=10us. Duty=1%
Spectral Width	$\sigma$			5.0	nm	RMS(-20dB), IFP=1200mA, PW=10us.Duty=1% Tc= 0°C to + 60°C
Rise Time/ Fall Time	$T_R/T_F$	-	-	2.0	ns	10-90% . 90-10%
Center wavelength	$\lambda_c$	-	1310	-	nm	RMS (-20 dB), IFP=1200 mA, PW=10us.Duty=1%
		-	1550	-		
		-	1625	-		
		-	1650	-		

## Dimensions(mm)

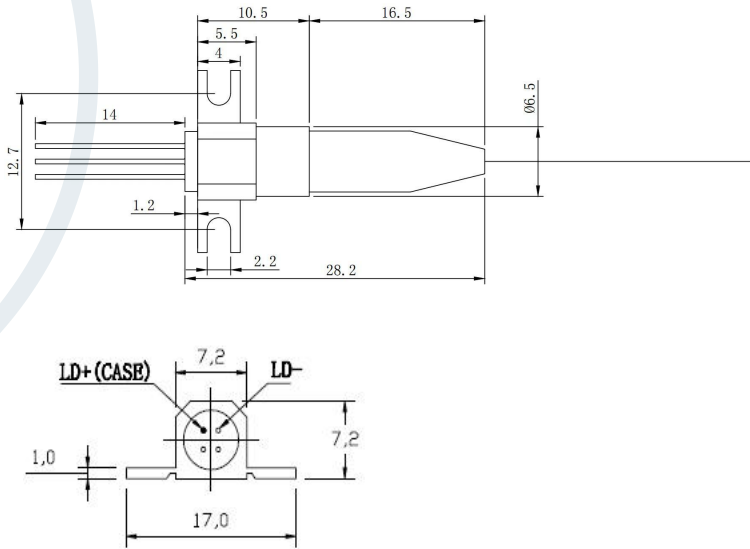

## Order Information

Part No.	Description
GTA1005	1310nm pulase laser with flange
GTA1005N	1310nm pulase laser without flange
GTA1006	1550nm pulase laser with flange
GTA1006N	1550nm pulase laser without flange
GTA1011	1625nm pulase laser with flange
GTA1011N	1625nm pulase laser without flange
GTA1012	1650nm pulase laser with flange
GTA1012N	1650nm pulase laser without flange

 Please let us know your request details before order.

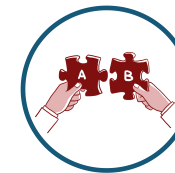

Customize for you

