



## TEC Monitor Photodetector Module ( To-5 8 pins)

### Features

- High Responsivity
- Front Side illuminated
- Double-side Pads
- Built-in TEC ,Thermistor
- Hight Reliability

### Application

- For Near-infrared Sensing
- Monitoring and Meter
- Optical Instruments

### Absolute Maximum Ratings (Tc=25°C .unless otherwise specified)

Parameter	Symbol	Min.	Max.	Unit	Test Condition
Relative Humidity	R <sub>H</sub>	-	80	%	-
Case Operating Temperature	T <sub>OP</sub>	-20	+70	°C	-
TEC Cooler Current	I <sub>cooler</sub>		1.1	A	-
TEC Voltage	V <sub>TEC</sub>		0.85	V	-



## Operating Conditions

Parameter	Symbol	Min.	Typ.	Max.	Unit	Test Conditions
Thermistor	Rth	9.5	10	10.5	KΩ	25°C
Thermoelectric Cooler Current	I <sub>COOLER</sub>	-	-	1500	mA	CW, -5°C ~ 60°C
Thermoelectric Cooler Voltage	V <sub>COOLER</sub>	-	-	1.5	V	CW, -5°C ~ 60°C

## Specifications (electrical & optical characteristics ) T= 25°C

Parameter	Symbol	Min.	Max.	Unit	Test Conditions
Storage Temperature	Tst	-40	+100	°C	-
Operating Temperature	Top	-40	+85	°C	-
Relative Humidity	RH	-	95	%	Top < 30°C
Wavelength Range	λ	900	1700	nm	-
Responsivity	R	0.95	-	A/W	1310nm
		1.05	-	A/W	1550nm



Dark Current		-0.5	-20	nA	-5V
Breakdown		-30	-40	V	-10 uA
Power Range	P	-70	36	dBm	TR = 5V
Forward Voltage		0.4	0.6	V	1mA
Band Width			0.02	GHz	-3dB
Thermal Electric Cooler		-	0.85	V	Voltage
		-	1.1	A	Current



## Pin Assignment

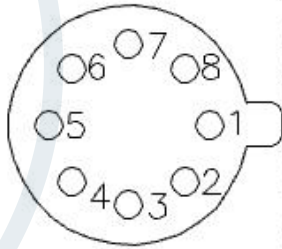

- 1:TEC+
- 2:Thermistor
- 3:Thermistor
- 4:PD+
- 5:PD-
- 6:NC
- 7:NC
- 8:TEC-

## To-Can

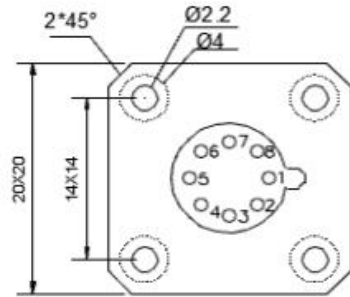
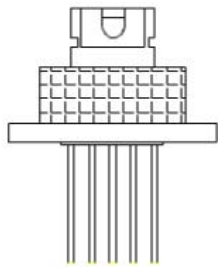

- 1:TEC+
- 2:Thermistor
- 3:Thermistor
- 4:PD+
- 5:PD-
- 6:NC
- 7:NC
- 8:TEC-

## Order Information

- GTA206E (InGaAs Pin 2000um)
- GTA207E (InGaAs Pin 1000um)
- GTA209E (InGaAs Pin 5000um)
- GTA210E (InGaAs Pin 10000um)



Please let us know your request details before order.



Customize for you

