

■ 安装连接尺寸 Installation Size

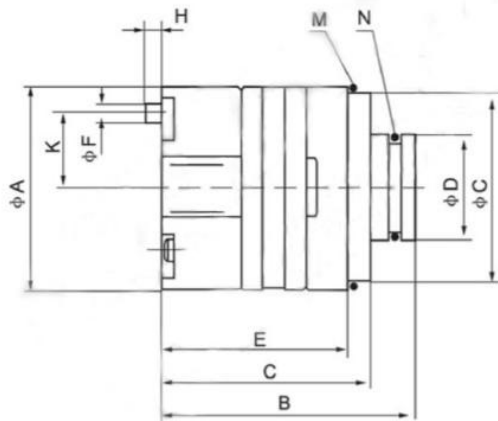

| 系列号<br>Models | A     | B     | C   | D  | E  | F | G    | H | K   | M         | N        |
|---------------|-------|-------|-----|----|----|---|------|---|-----|-----------|----------|
| PV2R1         | 68    | 84    | 70  | 35 | 62 | 6 | 62.7 | 5 | R25 | 59.4×3.1  | 29.4×3.1 |
| PV2R2         | 90    | 109   | 93  | 52 | 82 | 6 | 84.7 | 5 | R36 | 84.4×3.1  | 45.7×3.5 |
| PV2R3         | 120.5 | 127.5 | 106 | 72 | 94 | 8 | 115  | 8 | R48 | 114.4×3.1 | 65.0×3.5 |

| 系列号<br>Models | 转子内花键齿廓参数 Spline teeth No. in rotor |                    |                         |                      |                      |                          |
|---------------|-------------------------------------|--------------------|-------------------------|----------------------|----------------------|--------------------------|
|               | 模数<br>Modulus                       | 齿数<br>No. of teeth | 标准压力角<br>Standard angle | 大径<br>Major diameter | 小径<br>Minor diameter | (节径圆)弧齿槽宽<br>Space width |
| PV2R1         | 0.75                                | 24                 | 45°                     | 19.050               | 17.550               | 1.328                    |
| PV2R2         | 1.0                                 | 24                 | 45°                     | 25.400               | 23.400               | 1.771                    |
| PV2R3         | 1.0                                 | 28                 | 45°                     | 29.400               | 27.400               | 1.771                    |

■ PV2R系列泵芯 PV2R Series Cartridge Kit

| PC-   | PV2R         | -23  | -R   |
|---|--------------|--|--|
| 泵芯标记<br>Cartridge kit mark  | 系列号<br>Model | 公称排量<br>Displacement code(ml/r)            | 油泵旋向<br>Rotation   |
| PC: 单泵泵芯 & 双联泵前泵芯<br>PC: Single pump kit &<br>Double pump Front kit | PV2R1        | 6, 8, 10, 12, 14, 17, 19, 23, 25, 28, 31   | (从轴端看)<br>(Viewed from the shaft end)<br><br>R-顺时针<br>R-Right rotation<br><br>L-逆时针<br>L-Left rotation |
|   | PV2R2        | 26, 33, 41, 47, 53, 59, 65, 75             |  |
| PCT: 双联泵后泵芯<br>Double pump Rear kit                                 | PV2R3        | 52, 60, 66, 76, 85, 94, 116, 125, 136, 153 |  |
|   | PV2R4        | 136, 153, 184, 200, 237                    |  |