

diffuser

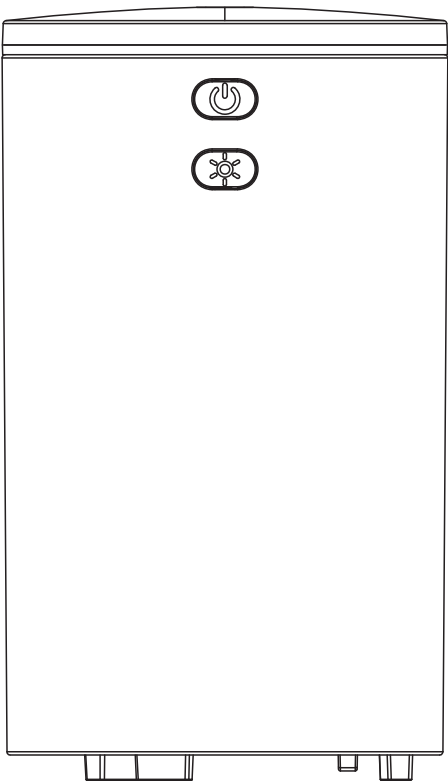

Note:Please add the water under the MAX Line

Ultrasonic car aromatherapy diffuser

Parts

- 1.mist outlet
- 2.cover
- 3.air outlet
- 4.machine
- 5.switch button
- 6.led button
- 7.drainage port
- 8.the max water line
- 9.water tank
- 10.DC power socket
- 11.USB cable
- 12.air inlet

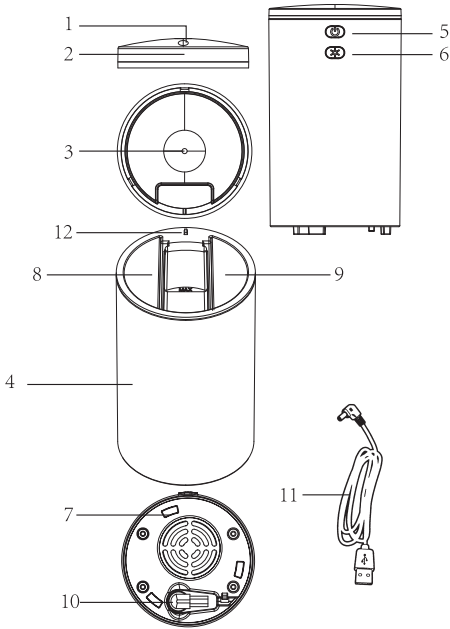

Operation guide

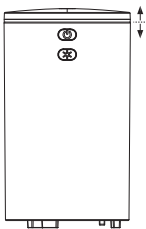

1.Open the cover

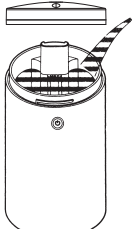

2.Add water under the max water line

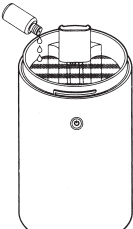

3.Add 2 to 3 drops of essential oils or fragrance

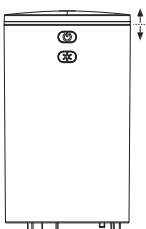

4.Cover the lid

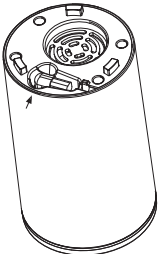

5.Plug the machine through the USB plug, and press the switch button to start the machine.

Car Diffuser Manual

Mini size,compact and easy to carry.
You can enjoy aromatherapy anytime and anywhere , it can be used in the car, office, travel, home.
Fresh mist can also be good for health care and make people relieve from stress.

Specifications

Product Size	70*70*122mm
Product Weight	150g
Color	White
Functions	Continuous Thin Mist Mode Continuous Thick Mist Mode 7 Color LED
Power	6W
Voltage	5V/1.2A
Capacity	100ml
Working Time	Continuous Mist Mode: Thick Mist-6 hours;Thin Mist -8 hours;
Accessories	Diffuser* 1;USB* 1;Manual* 1
Using Space	About 10-20 square meters

Malfunction analysis

Malfunction	Reasons	Ways of Solving
No Mist	Use tap water with too many minerals	Use distilled or purified water
	The water in the water tank is beyond the water line,used up or less.	
No Mist / Thin Mist	The machine needs to be cleaned, and the essential oil accumulated in the atomizer.	Use clean water, the atomizer needs to be cleaned with cotton swab.
	Water exceeds the max water line.	Pour out the exceed water beyond the water line and restart the machine.
Flickering Led Lights	Water droplets condense in the machine's vent.	Gently tap the lid to let the water droplets condensed in the mist drop back to the tank.
Only Droplets No Mist	Low water temperature	Pour the water out and change into room temperature water

- 1.Mist Button:
Press once: Turn on the machine with continuous thin mist mode
Press twice: Change to continuous thick mist mode.
Press third: Turn off the machine
- 2. Light button
Press once: Automatically rotating 7 colors led lights
Press twice: The led lights will be turned off.

Tips

- * The amount of mist will gradually increase with the water line decrease, but when reaching the 1/3 of max water line, the mist will gradually become thinner. This is a normal phenomenon. It is not a machine failure.
- * When there is no water / less water, the machine will shut off automatically .

Method of maintenance and cleaning

Please clean the machine before changing with different essential oils.
Because essential oil is corrosive, it will corrode the atomizer after long-term using.
To extend the life of the machine, you can use the following ways to clean the machine:
After turning off the machine,unplug the cable,take the cover ,pour the water out.
Use the water close to the room temperature to clean.
Rinse first and dry the water tank with clean cloth before changing another essential oils.
Clean the case with a damp cloth;
Use cotton swab or soft brush with rubbing alcohol to clean the atomizer;
Please preventing water into the air inlet during the cleaning process;
When adding full water,please do not stand upside down or put down the machine;
Do not use detergents and organic solvents or abrasives to clean the machine;
Please unplug the power when cleaning;
Place the unit on a dry and stable surface.

Precautions avoid damage to the product

- *Be sure to use the diffuser own USB cable
- *Please operate the machine according to the manual
- *To reduce the risk of electric shock, do not attempt to clean the unit by any means other than the "method of maintenance and cleaning " in the manual
- *When cleaning or maintaining the unit or not using the unit, turn off the power and unplug the USB power supply.
- *Do not add water more than 55 degrees Celsius to avoid damage the atomizer
- *Please add clean water to avoid clogging and destroying the atomizer
- *Do not pour water or any other liquid into the air inlet.
- *Do not touch the atomizer with your fingers or metal objects (highly sensitive) (otherwise the amount of mist will decrease)
- *After using, please pour out any liquid in the water tank to maintain the machine.
- *Do not use this unit when the cover is broken
- *Do not repair the machine without authorization
- *Please keep children and pets away from this machine