

HIGOLD®

High-End Kitchen Functional Hardware



INTELLIGENT FOOD PURIFICATION SINK

PRODUCT OPERATION INSTRUCTION

Intelligent Kitchenware Company

Foshan Shunde Higold Hardware Product Manufacturing Co., Ltd

T: +86 757 2738 6292

E: sales_sink@higold.com.cn



FOREWORD

Dear users !

Thank you very much for choosing our food purification series of smart kitchen utensils.

**Now you begin to become the most intimate food safety guard around,
Let you share delicious meals with your family.**

Please read this manual carefully before use and follow its requirements.

[Product Operation Instruction] is the control concept that has been tested and verified.

It is very important to maintain the good working condition and safe use of products. If the product fails due to improper use, it will be damaged.

**This Instruction is only suitable for Higold food purification series.
Higold reserves the right of final interpretation.**

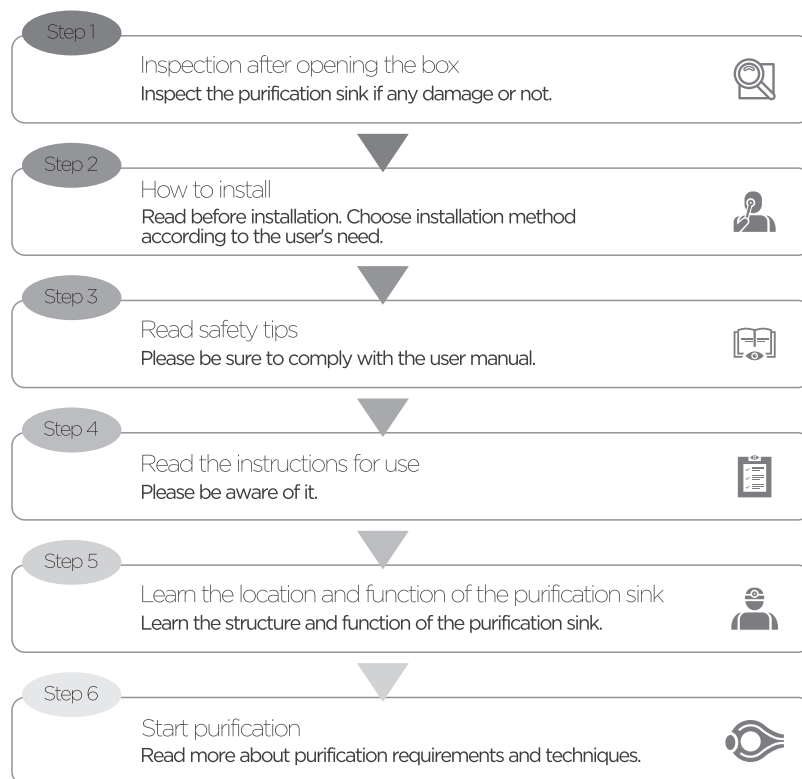

TECHNICAL SPECIFICATIONS

Series	Double Bowl Series	Single Bowl Series
Model No.	973005 / 973011	973006 / 973007
Rated Voltage	220V	220V
Rated Frequency	50Hz	50Hz
Rated Power	200W	200W
Overall Dimension	820*480*235mm	450*440*220mm / 495*450*220mm
Product Weight	11.5kg	8.5kg / 9kg
Operating Environment	Temperature: 5-45℃	Temperature: 5-45℃

- ① The product size is approximate, and the order is length X width X depth.
 - ② Specific product model and technical parameters are subject to the outer packing carton.
 - ③ The pictures provided in this manual are for reference only. Goods in kind prevail.
 - ④ Technical specifications in this manual are subject to change without prior notice.
- Executive Standard GB4706.1-2005

DIRECTORY

ONE	1. Product introduction	
	1.1 General Introduction	01
	1.2 Technical Principle	01
	1.3 Product Features	01
	1.4 Main Functions	02
	1.5 Application Range	02

TWO	2. Unpacking and Installation	
	2.1 Inspection after Opening the Carton	03
	2.2 Installation of Purification Sink	04
	2.3 Requirements on Heat Dissipation/Air Inlet	07
	2.4 Electrical Principle and Connection Description	08
THREE	3. Precautions	
	3.1 During Installation	09
	3.2 Before Use	09
	3.3 In Use	10
FOUR	4. Instructions for Use	
	4.1 Before Purification	11
	4.2 During Purification	11
	4.3 After Purification	11
FIVE	5. Function Introduction	
	5.1 Structural Diagram	12
	5.2 Introduction to Operation Panel	13
	5.3 Operating Instructions	13
SIX	6. Maintenance	
	6.1 General Knowledge to Maintenance	15
SEVEN	7. Common Malfunctions	
	7.1 Power button cannot be turned on or automatically reset	15
	7.2 Button skips or doesn't work when touched	16
	7.3 Purification effect is obviously reduced	16

PRODUCT INTRODUCTION

1.1 General Introduction

Higold Intelligent Food Purification Sink is one of the innovative new products researched and developed by Higold professional R&D team. On the basis of focusing on innovative technology, the sink is made of eco-friendly and food-grade 304 stainless steel.

The product uses double catalyst purification technology to lead the world's purification industry level. Higold Purification Sink owns a number of national invention patents. The residues of pesticides, hormones, accrue, ripener, bacteria, virus, parasite or microbial on fruits, vegetables, meat, grain and tableware before and after purification are tested by authoritative national testing center. The test result shows the product is safe and reliable. It has also obtained CGC Product Certification and sales license for household appliances. It is an intelligent food purification sink safeguarding food security for human.

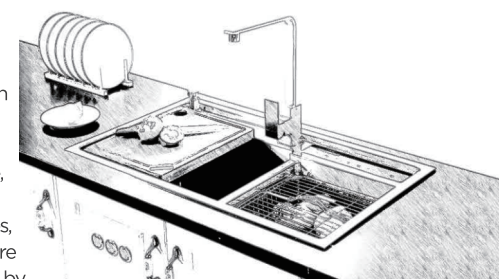

1.2 Technical Principle

1. Water and electricity are detoxification materials, without adding any chemical components like cleanser or disinfectant.
2. The physical and mechanical reaction of the dual catalyst generator makes the water molecule change into hydroxyl radical (OH).
3. Hydroxyl radical and UV combine to form a double catalyst, which has super detoxification, sterilization and other purification effects.
4. After detoxification and purification, the double catalyst is restored to water after about 15 seconds, with inhibitory effect.

1.3 Product Features

The product is green and eco-friendly, no additive, no residue, no chemical and no damage. It is an energy-saving innovative product from water and restored to water.

1.4 Main Functions



Detoxification

Under the reaction of double catalyst, the oxidation reaction of pesticide residues, hormones, antibiotics, ripener and other organic toxins occurs rapidly, which decomposes the toxicity and makes it become carbon dioxide, inorganic salt and water. The test result shows that, over 95% of pesticide residues are removed and 99% of hormones, antibiotics and ripener are removed.



Sterilization

Under the reaction of double catalyst, it penetrates quickly and destroys the microbial cells, leading to the metabolic killing of bacteria, viruses and other harmful substances and inhibiting their reproduction. The test result shows that, bacterium, virus and microbe can be killed as high as 99%.



Freshness Retaining

Peripheral and permeable fine molecular water is less easy to dissociate from food, effectively absorbed by meat, fruits and vegetables, decomposition of its body odor or artificial added, such as: clenbuterol, ripening agent, ethylene, alcohol and other harmful substances, making the original taste more pure and slow metabolism and playing a role in freshness retaining.



Cleaning

Fine molecular water makes the sediment, dirt, parasites and microorganisms on food surface fall off easily, so that the purification effect is better with cleaner surface.

1.5 Application Range

1. Family
2. Canteen of university, high school, middle school, primary school, kindergarten, etc.
3. Canteen of company, factory, shopping mall, etc.
4. Hotel and dining establishment
5. Canteen of government, army and other institutions



UNPACKING AND INSTALLATION

2.1 Inspection after Opening the Carton

When opening the package, please check the following contents carefully:

1. Whether there is any deformation on the bowl, panel and bottom due to crash or heavy pressure.
2. Whether the touch panel is uneven or cracked by crash.
3. Whether the main purification board and control module are loose or fall off.
4. Whether the power cord is damaged or loose.
5. Check whether the data marked on the rating label on the sink is consistent with the local power grid.



- When installing the purification sink, please power on and get normal operation before installation in order to eliminate the malfunctions caused by improper transportation.
- When the purification sink is damaged or not working properly, stop using it immediately and unplug it.
- Please contact the local dealer or call the after-sales service department for maintenance.
- The purification sink is maintained by professionals trained by the manufacturer. Please do not detach/repair it by yourself.

2.2 Installation of Purification Sink

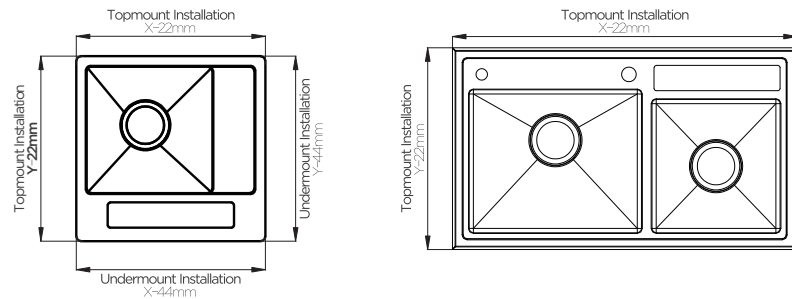

NO.	Name	Picture	Quantity
A	Sink		1
B	Box for Topmount Clips		1
C	Waterproof Sponge Strip		1
D	Box for Undermount Clips		1

Note: Glass glue and marble glue are needed for undermount installation.

Cutout Hole (Choose the corresponding hole size according to the product. Draw the lines and cut the hole after measuring the size.)

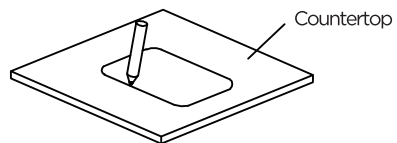

Topmount Installation Diagram

Stick the waterproof sponge strip under the rim of the sink.

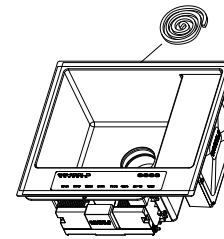

Increase the number of clips and adjust the location according to the flatness of the sink.

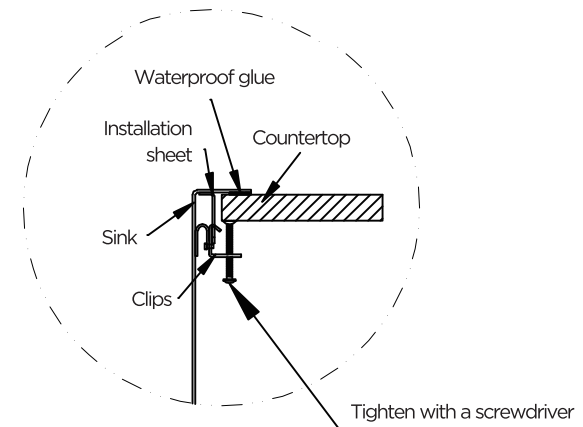
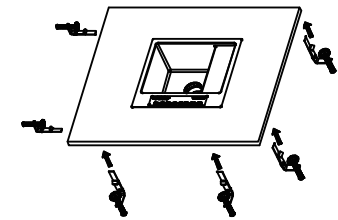

Undermount Installation Diagram

Step 1: Fix the nut and open the hole

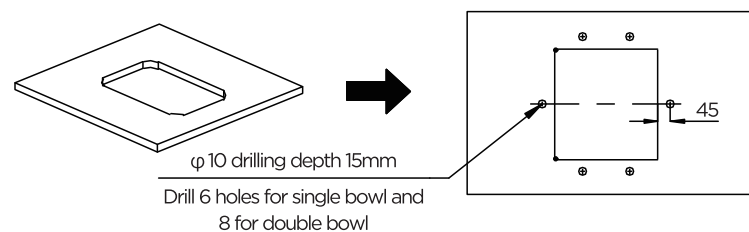

Step 2: Install plastic nut

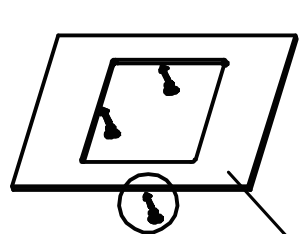

Step 3: Install the sink

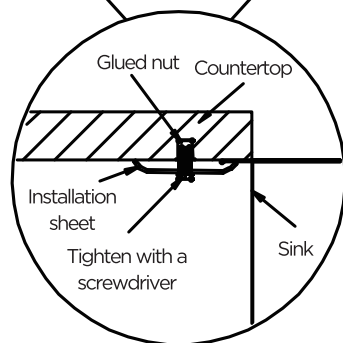
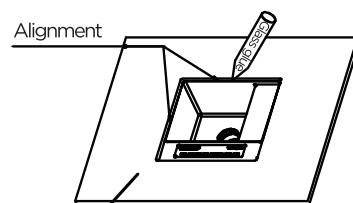

2.3 Requirements on Heat Dissipation/Air Inlet

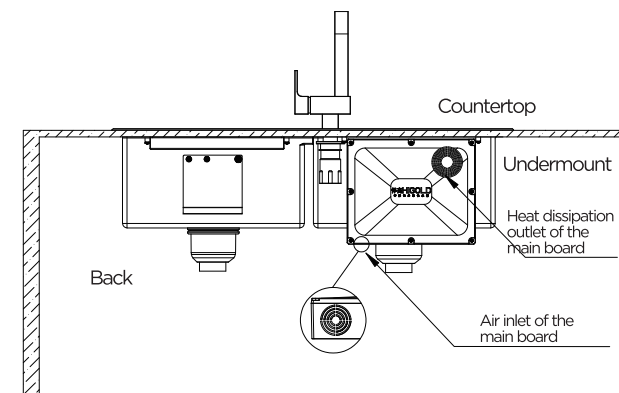

Requirements to heat dissipation outlet of the main board

1. The heat dissipation outlet of the main board is strictly prohibited to be covered by objects and at least 80mm beyond the heat dissipation outlet.
2. The heat dissipation outlet of the main board is strictly prohibited from being drenched or soaked by water.
3. The heat dissipation outlet of the main board is strictly prohibited to insert objects from the outlet.
4. Maintain air circulation around the front of the heat dissipation outlet.
5. If the heat dissipation outlet is shielded by wall or a flat object, a φ80 hole should be opened.

Requirements to air inlet of the main board

1. The air inlet of the main board is strictly prohibited to be covered by objects and at least 80mm beyond the air inlet.
2. The inlet of the main engine is strictly prohibited from being drenched or soaked by water.
3. The air inlet of the main board is strictly prohibited to insert objects from the inlet.
4. Maintain air circulation in front of the air inlet.

2.4 Electrical Principle and Connection Description

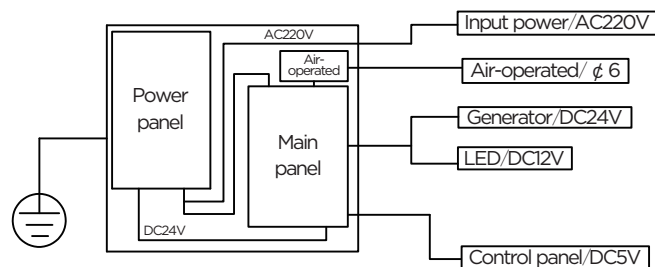

Connection Instructions

1. Confirm to turn off the switch on the host before connecting.
2. Plug in the power cord with 3C certification correctly.
3. Install the socket with effective ground wire correctly in the best position of moistureproof and waterproof.
4. Plug the power cord into the socket and turn on the bottom switch of the purification machine.
5. Operation and use.

PRECAUTIONS



If the supply cord is damaged, it must be replaced by the manufacturer, its service agent or similarly qualified persons in order to avoid a hazard.



This appliance can be used by children aged from 8 years and above and persons with reduced physical, sensory or mental capabilities or lack of experience and knowledge if they have been given supervision or instruction concerning use of the appliance in a safe way and understand the hazards involved.



Children shall not play with the appliance.



Cleaning and user maintenance shall not be made by children without supervision.



Keep the appliance and its cord out of reach of children less than 8 years
This appliance is intended to be used in household and similar applications such as:

- staff kitchen areas in shops, offices and other working environments;
- farm houses;
- by clients in hotels, motels and other residential type environments;
- bed and breakfast type environments.

3.1 During Installation



The front of the power outlet at the cabinet should not be covered.



In order to ensure the normal use of the product and the safety of electricity consumption, please use the 10A socket matching with the product during installation.



Live operation is strictly prohibited during installation or maintenance.



The power supply of the product is 220V/50Hz. It is strictly prohibited from being drenched or soaked by water.



In order to ensure safety use, Higold Intelligent Food Purification Sink should be equipped with an independent socket and properly connected with ground wire. It is strictly prohibited to use the sink without connecting ground wire.



After installation, please dispose the packing materials properly. Please do not allow children to play with plastic film and styrofoam, as asphyxia or other safety accidents may occur. Please keep children away from the packing materials.

3.2 Before Use



Do not plug in or pull out the power cord when your hand is wet. Do not hold the cord when plugging in or pulling out the power cord.



When using the purification sink for the first time, firstly clean the inside of the sink and the inside of the purification generator. Then put in tap water. The water level shall not be lower than the lowest water level in the sink. Turn on power and make it work for 2-3 times and then drain the water.

3.3 In Use



If there is no reaction or effect of purification in use, please consult to the after-sales or professional personnel for inspection and maintenance. Do not open the electronic control components without permission.



In case of abnormality or peculiar smell in use, please immediately unplug the power supply and consult to the after-sales or professional personnel for inspection and maintenance. Do not open the electronic control components without permission.



If the key is not sensitive in use, please check whether there is sundry or water droplet on the key, or consult to the after-sales or professional personnel for inspection and maintenance. Do not open the control panel without permission.



Children or people without relevant knowledge and experience, as well as people with physical, perceptual or mental disability, must use the product under the supervision and guidance of a safe guardian.



When the electronic control parts need to be repaired, please consult to the after-sales or professional personnel for maintenance. Do not replace the parts without permission. Using improper parts may cause further damage to the product.



INSTRUCTIONS FOR USE

4.1 Before Purification

1. The purification sink supports municipal tap water (not pure water or dirty water).
2. The indoor temperature should be within 3-45℃ when using Higold Intelligent Food Purification Sink. It is strictly prohibited to operation the machine at a temperature beyond this.
3. When purifying fruits and vegetables, please clean the sediment, dirt and other sundries first before putting them into the purification sink for purification.
4. When purifying meat, cut it into 2mm-5mm thick for purification after cleaning it, so as to ensure the best purification effect.
After purification, clean the purification generator and the inside of the sink.
5. Maintain the current state of fruits and vegetables during purification. Process after purification. Further damage.

4.2 During Purification



Purified water can be used 1-2 times for purification. Do not use it repeatedly for many times, so as to ensure the freshness of food.



At places where water quality is hard, there may be some white sediments at the bottom of the sink after purification. This is normal phenomenon. Just clean it after use.

4.3 After Purification

1. After use, rinse the generator for 1-2 minutes with a nozzle faucet from the filter mouth.
2. If the product is not used for a long time, please do not store water in the sink for a long time. Keep the product dry and clean.
3. After the purification sink is used for half a year, the generator needs to be maintained and cannot be started up.

FUNCTION INTRODUCTION

5.1 Structural Diagram

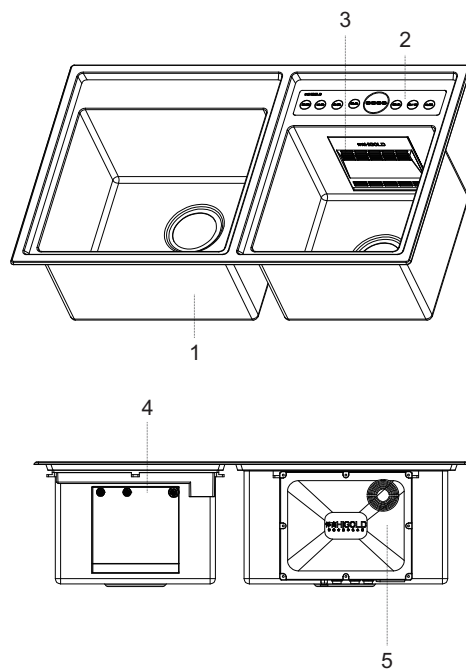

- ① Sink body
- ② Operation panel
- ③ Purification filter
- ④ Purification generator
- ⑤ Automatic drainer

5.2 Introduction to Operation Panel



- ① [Display Screen] working time
- ② [Power] function button
- ③ [Start/Pause] function button
- ④ [Wifi] APP button
- ⑤ [Fruit/Veg] function button
- ⑥ [Meat] function button
- ⑦ [Grain] function button
- ⑧ [Dishes] function button

5.3 Operating Instructions



Press the [console] button (the water seal cap of the sewer is closed)



Make sure that the power switch is turned on, put the food to be purified in the sink and add an appropriate amount of water, the water level must not be lower than the lowest water level in the sink (covering the generator filter).



Long press the power button for 3 seconds to enter the standby mode of the purification system.



Select the food button and click it , if vegetables, click the [fruits and vegetables] button.



Then click the [start / stop] button, the purification system starts to work, and the display shows the countdown working time.



When the purification is completed, it will stop purification automatically and ring five times to indicate the end of purification.



Pull the [console] button to drain water.



Or click the [power] button to turn off the system.



The food can be taken out after the work.



Use the faucet with nozzle to wash the generator and sink.

MAINTENANCE

6.1 General Knowledge to Maintenance

- The interior of the sink can be cleaned with cleaning fluid (e.g. detergent).
- When cleaning the purification generator, spray some white vinegar into the inside of the generator from the filter mouth. After waiting for 5-10 minutes, rinse with a nozzle faucet from the filter mouth for 1-2 minutes.



COMMON MALFUNCTIONS

7.1 Power button cannot be turned on or automatically reset

Possible reasons:

- ① No power connection.
- ② The purification main machine is not switched on.
- ③ There are sundries in the generator.

Maintenance methods:

- ① Check whether the power is connected.
- ② Check whether the purification main machine is switched on.
- ③ Rinse with a nozzle faucet from the filter mouth.

7.2 Button skips or doesn't work when touched

Possible reasons:

① There is water or sundry on the touch glass panel.

Maintenance methods:

① Turn off the power and clean up the sundry or water on the touch glass panel. Then restart the purification main machine.

7.3 Purification effect is obviously reduced

Possible reasons:

① The generator electrode plate has dirt.

② The input voltage is below 198V.

Maintenance methods:

① Clean the generator with maintenance method.

② Check whether the input voltage is within the range of 198-245V.

