







Floor Cabinet User Manual

1.Installation Tools

						
Screwdriver	Hammer	Tape Measure	Impact Drill	Wrench	Pencil	Spirit Level

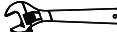
2.Installation Diagram

•The diagram illustrates the following hole positions:

- A: Mirror cabinet fixing hole
- B: Base cabinet fixing hole
- C: Hot and cold water inlet holes
- D: Wall drain outlet hole
- F: Power cord

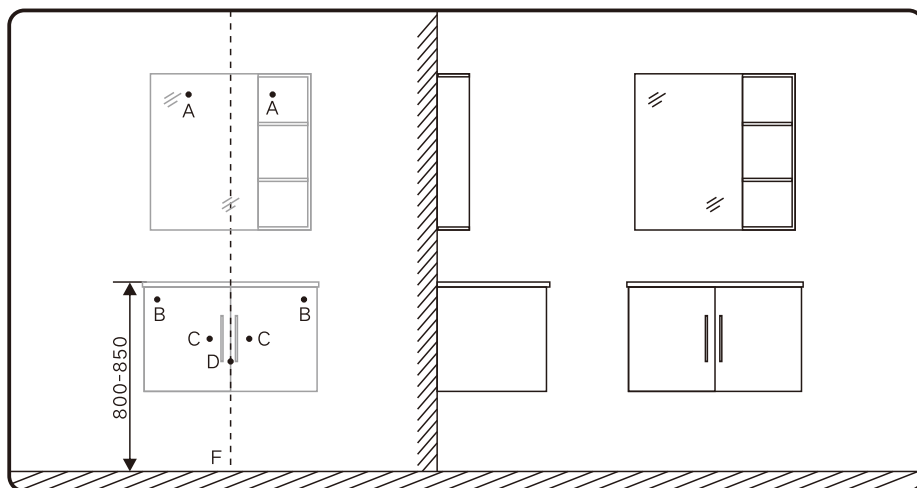

•Note: The diagrams in this manual are for reference only and are not actual images. Please verify the installation data on-site. If there are discrepancies, please measure based on the actual product. No further notice will be given

3.Floor cabinet installation steps

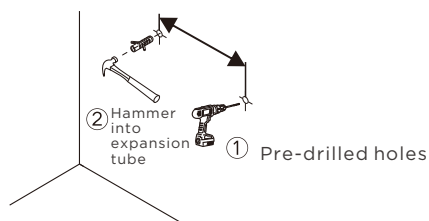
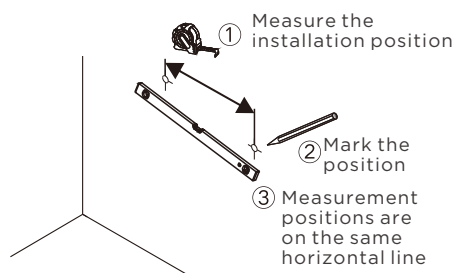

•1. Select the installation location of the floor cabinet on the wall, then use a pen to mark the drilling location, and use a level to ensure that the holes are on the same horizontal line. (The recommended installation height of the floor cabinet is 800-850mm. Please customize the installation location according to the actual situation. The smart model needs to reserve a power supply

•2.Use an impact drill to pre-drill the hole, and then use a hammer to knock the expansion tube into the hole.

•3.Align the back tie bar of the floor cabinet with the expansion tube on the wall, screw the screws into the expansion tube, fix the floor cabinet to the wall, and the installation of the floor cabinet is completed.

