

DB Series Clothes Dryer

1.Product Introduction

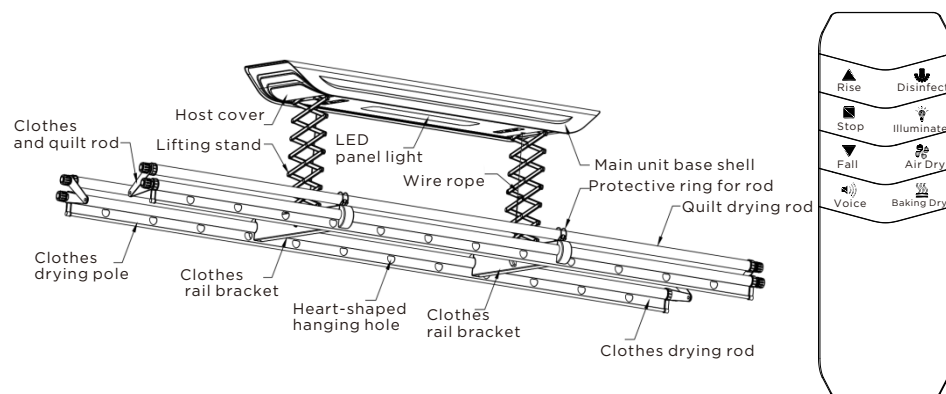

2.Installation Instructions

- 1.Ensure that the surface to be installed is flat, solid, and will not leak or seep water.
- 2.Ensure that the input power voltage is between 220V-/50Hz, and install a leakage protection switch with a grounding wire.
- 3.Please turn off the power during installation and ensure that the power cord is long enough to connect to the main unit of the clothes rack.
- 4.If there is a balcony light installed previously, please turn off the power and remove the balcony light first.
- 5.Take out the "positioning template" from the packaging box and paste it in a suitable position on the top of the balcony, ensuring it is level and straight (as shown in Figure 1).
- 6.According to the positioning holes on the "positioning template," use an impact drill to make 4 holes of 10mm60mm (M8*70 expansion screws), then install the provided expansion screws.
- 7.Take out the -shaped quick-install bracket and install it in the direction shown in Figure 2. Adjust the position and tighten the washers and nuts (as shown in Figure 2).

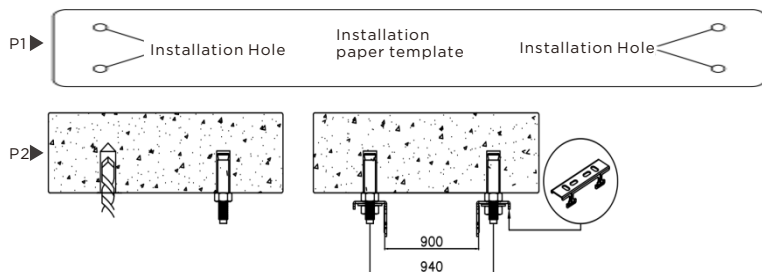

DB Series Clothes Dryer

•8. Take out the main unit from the packaging box, carefully lift the box, then hold the main unit level with both hands and align it with the -shaped quick-install bracket. Push the main unit in the direction of the arrow and adjust its position until the buckle fully snaps into the buckle eye (as shown in Figure 3).

•9. Properly connect the wires (Note: brown wire connects to the live wire, blue wire connects to the neutral wire, and yellow-green wire connects to the ground wire) (as shown in Figure 4). Then wrap the connections with insulating tape and tuck them into the gap between the main unit and the ceiling. Insert the four anti-slip rubber pads into the four corners (as shown in Figure 5).

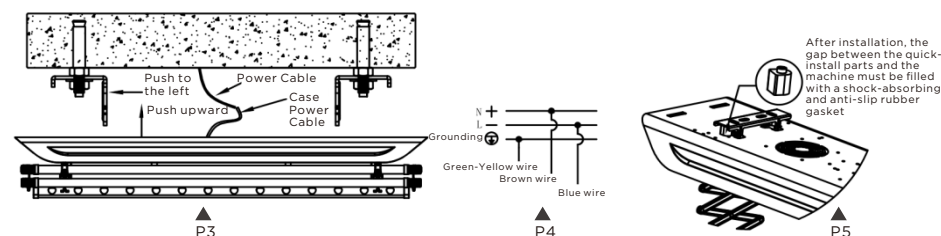

3.Installing the Clothes Rod Crossbar

•As shown in the diagram, insert the crossbar into the crossbar connecting cover, and fix the crossbar and the crossbar connecting cover together with 2 M4*8 countersunk screws. Install the other set of crossbars in the same way and attach the clothes rod bracket cover (as shown in P6).

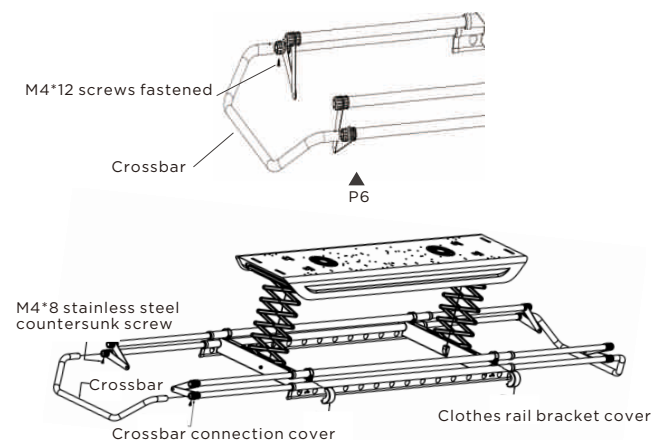

4.Remote Control Pairing Settings

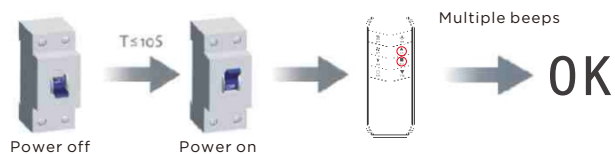

•When the main unit is powered on and a long beep is heard, simultaneously press the " " (up) and " " (stop) buttons or the " " (up) and " " (down) buttons on this remote control within three seconds. Wait for the machine to emit several consecutive "beep" sounds, indicating successful pairing.

5. Remote Control Usage

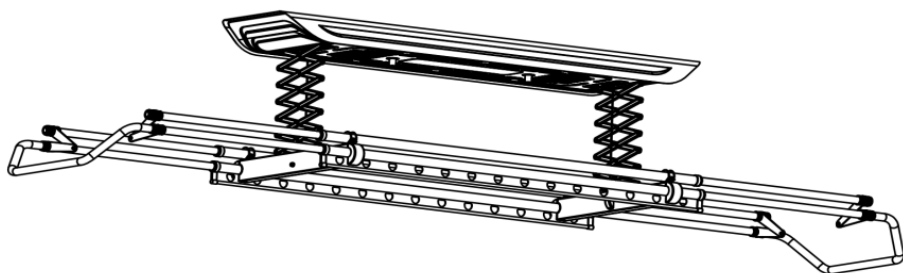

- 1.Up: Press the "Up" button, and the drying rod will automatically rise. It will stop automatically when it reaches the maximum position.
- 2.Stop: Press the "Stop" button while the drying rod is moving up or down, and the drying rod will stop.
- 3.Down: Press the "Down" button, and the drying rod will automatically descend. It will stop automatically when it reaches the minimum position.
- 4.Lighting: Press the "Lighting" button to turn on the light. Press the "Lighting" button again to turn off the light. The light will automatically turn off after 2 hours of continuous operation.

•5.Sterilization (for specific models): Press the "Sterilization" button to turn on the sterilization lamp. Press the "Sterilization" button again to turn off the sterilization lamp. It will automatically turn off after 30 minutes of continuous operation.

•6.Drying (for specific models): Press the "Drying" button to turn on the drying function. Press the "Drying" button again to turn it off. The drying function will automatically turn off after 120 minutes of continuous operation.

6.Basic Parameters

Product Name	Electric Clothes Dryer	Electric Clothes Dryer	Electric Clothes Dryer
Product Model	800233-DB9S, 800233-DB9G	800252-DB11-1	800239-DB3-2A 800240-DB3-2
Rated Voltage	220V~	220V~	220V~
Rated Frequency	50Hz	50Hz	50Hz
Rated Power	75W	650W	75W
Main Unit Dimensions	1300*326*82mm	1300*326*82mm	995*303*80mm
Drying Rod Length	2180mm (excluding curved tube)	2180mm (excluding curved tube)	1570mm
Lifting Travel	1.09m	1.09m	1.03m
Execution Standard	GB 4706.1-2005		

•Note: The drying rod length includes the length that needs to be screwed in at both ends.