

Instruction Manual

Three - Function Thermostatic Shower Set with Storage Instruction Manual

Please read the instruction manual carefully and keep it properly before using the product.

1. Product Installation Diagram

Notice:
Before installation and use, be sure to carefully read all contents of this installation and operation manual!
After opening the product package, first carefully check the accessories according to the above table and diagram. If there is any shortage, please immediately contact the local distributor.
Tools required for installation:
Adjustable wrench, Allen wrench, Phillips - head screwdriver, impact drill, hammer, safety goggles, PTFE tape, spirit level.

Standard Accessories List

Serial No.	Name	Quantity
1	Main Body	1
2	Shower Pipe Set	1
3	Fixed Base Accessory Pack	1
4	Overhead Shower	1
5	Handheld Shower	1
6	Shower Hose	1
7	Elbow	2
8	Instruction Manual	1

Installation Auxiliary Tools

Hammer	Spirit level	Adjustable wrench
Glue (do not use glue containing acetic acid)	Impact drill	Screwdriver

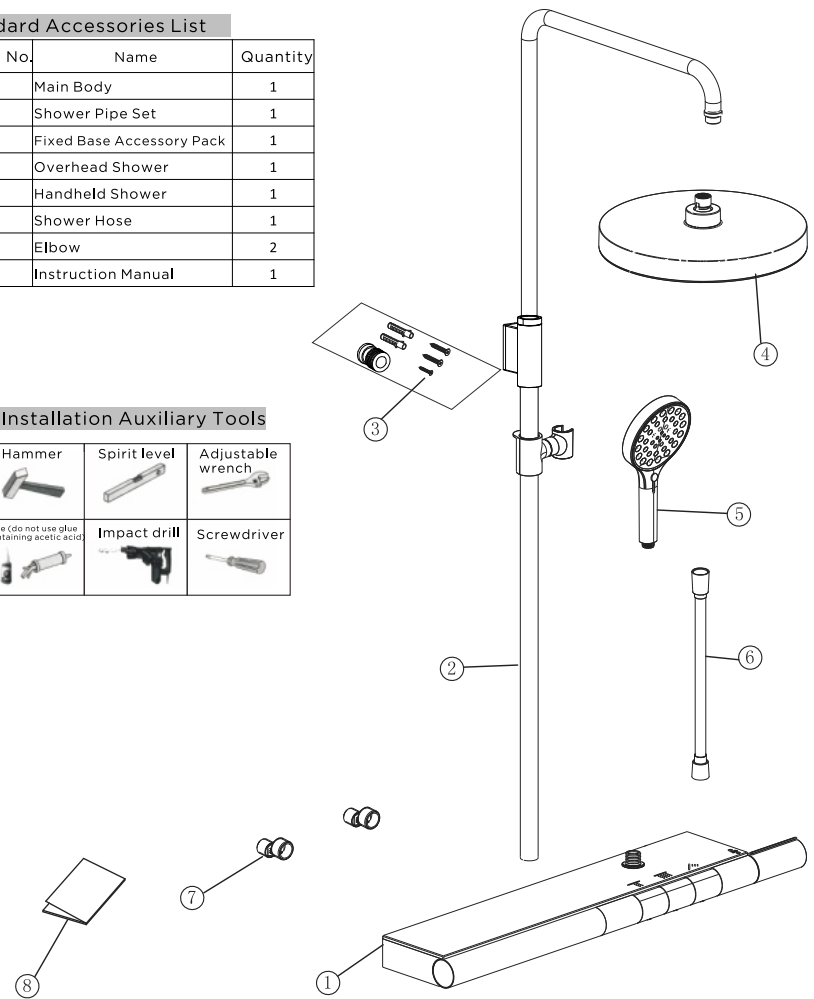

2. Installation Steps

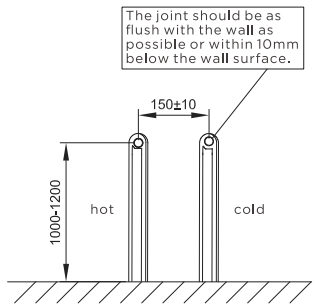

1. Before installation, ensure that the two water outlets are on the same horizontal line, and make sure the deviation in the distance between the two water outlets is within the allowable range. Connect the cold and hot water sources according to the method of hot on the left and cold on the right.

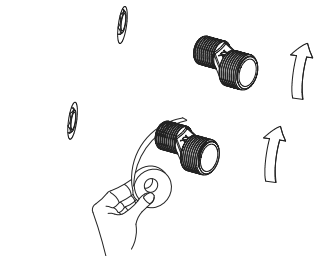

2. Wrap the elbow with PTFE tape, then connect it to the pre - embedded water outlet pipe joint.

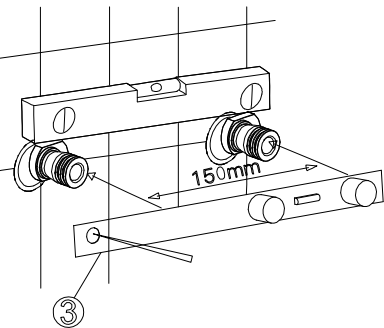

3. Use a spirit level (3) to confirm the distance between the joints of the two elbows (150mm), and adjust the two elbows so that the upper surfaces of the joints of the two elbows remain horizontal. Mark the left hole position with a pencil.

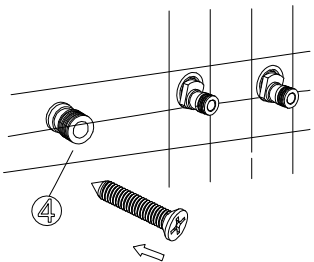

4. Fix the joint with a screw at the marked position.

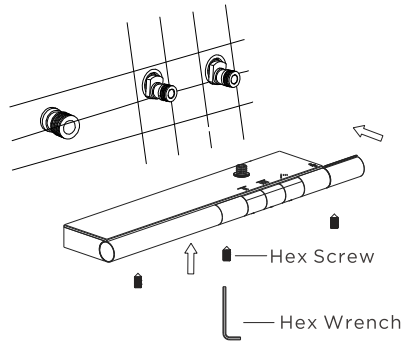

5. Insert the faucet body into the elbow, use a hex wrench to tighten the set - screw inside the faucet body, ensuring the upper surface of the body is in a horizontal state.

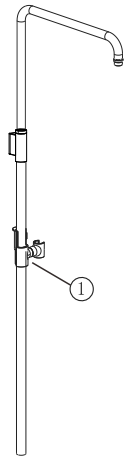

6. Connect the L - shaped pipe, fixed base, and straight pipe together; separate bracket and install it on the straight pipe at a suitable position.

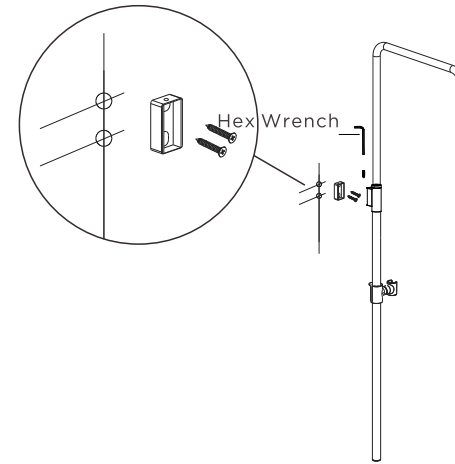
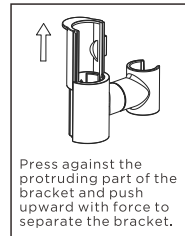

9. Use a hex wrench to disassemble the fixing sleeve, and fix the removed part on the wall with screws.

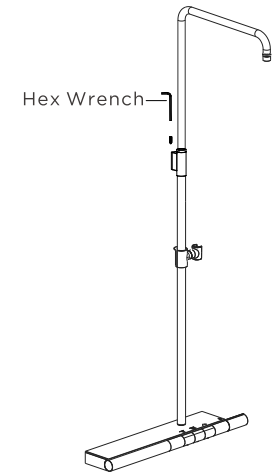

10. Install the shower pipe assembly onto the main body, then use a hex wrench to lock the fixing sleeve.

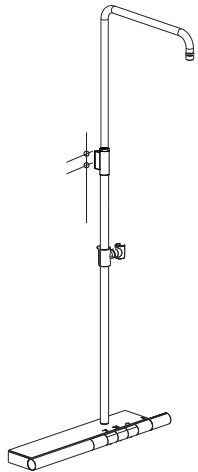

7. Fix the shower pipe assembly to the main body, then mark the position of the fixed base.

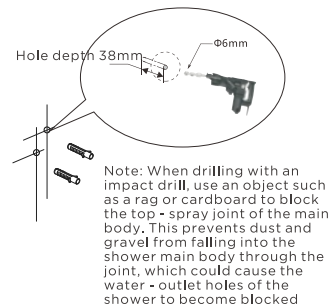

8. After moving the shower pipe assembly away, drill a hole at the marked position and drive the expansion plug into the hole.



11. Install the shower hose, handheld shower, and overhead shower; installation is complete.

3. Installation Precautions

1. This product is delivered to consumers after strict quality inspection. Do not disassemble or assemble it by yourself!
2. Before installing the shower, please thoroughly flush the water pipeline to prevent impurities in the pipeline from blocking the shower and affecting its normal use.
3. Please install according to the product installation dimension diagram to ensure correct installation. Do not force installation to avoid damaging the shower and its parts.
4. The connection of the shower to the cold and hot water supply pipes must be correct. Facing the shower, the left side connects to hot water, and the right side connects to cold water.
5. After installing the shower, turn on the water source and check for any leaks at the connections.
6. The applicable temperature range for the shower: hot water supply temperature 55°C - 85°C, cold water supply temperature 4°C - 29°C. It is recommended that the incoming hot water temperature be 55°C - 65°C. The applicable water pressure range for the shower: 0.05Mpa - 0.75Mpa, recommended 0.1Mpa - 0.5Mpa.

4. Product Maintenance and Care

To keep the shower clean and bright, please follow these care methods:

1. Under normal circumstances, simply rinse with water and wipe dry with a soft cotton cloth.
2. If water alone cannot clean it thoroughly, use a mild cleaner. After cleaning, rinse the shower with water and wipe dry with a soft cotton cloth.
3. Do not use any abrasive cleaning tools to clean the shower, such as metal brushes or scouring pads.
4. Do not use any acidic, alkaline, or abrasive cleaners to clean the shower, such as cleaning powder.
5. During periods of unoccupancy, please close the main water inlet valve at your home to avoid damage to the product from pipeline pressure changes.
6. When the temperature, especially near the shower, is below 0 , close the main water valve and empty the remaining water in the pipes and the shower to prevent internal freezing and cracking of the shower and pipes.

5. Usage Instructions

- A: Shower water - function button
B: Rotate the handwheel to select the temperature level

6. Usage Precautions

When rotating the handwheel to adjust the temperature, do not use excessive force. The torque should not exceed 4N.M to avoid damaging the faucet. During use, when the water flow from the faucet significantly decreases, please clean the showerhead filter and the rubber - particle holes of the showerhead to prevent affecting water output or causing blockage and bursting.

Example: If the water flow from the showerhead significantly decreases or some rubber particles do not discharge water, please rub the showerhead rubber particles by hand or use a sewing needle (toothpick) to clear the rubber - particle holes.

7. Warning

Before installing the shower, please thoroughly flush the water pipeline to prevent impurities in the pipeline from blocking the shower and affecting its normal use.

