

ANSI/ASME B 18.2.2

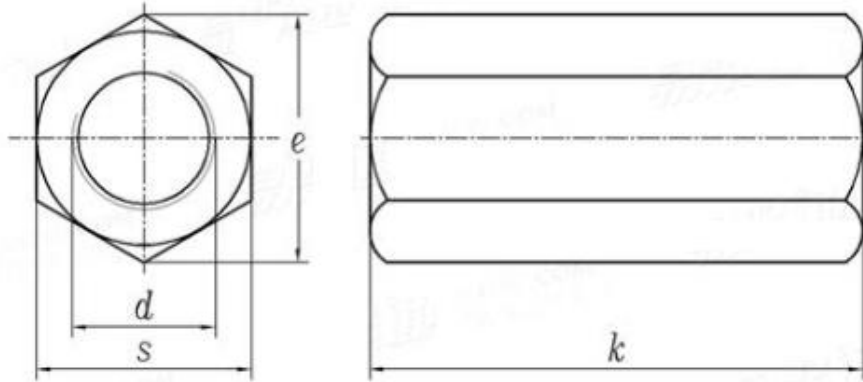

Unit: inch



Screw Thread		6#	8#	10#	1/4	5/16	3/8	7/16	1/2	9/16	5/8	3/4	7/8
	d	0.1380	0.1640	0.1900	0.2500	0.3125	0.3750	0.4375	0.5000	0.5625	0.6250	0.7500	0.8750
PP	UNC	32	32	24	20	18	16	14	13	12	11	10	9
s	min	0.302	0.302	0.302	0.428	0.489	0.551	0.607	0.663	0.782	0.782	0.963	1.212
	max=nominal size	0.312	0.312	0.312	0.438	0.500	0.562	0.625	0.688	0.813	0.813	1.000	1.250
e	min	0.344	0.344	0.344	0.488	0.557	0.628	0.692	0.756	0.891	0.891	1.097	1.382
	max	0.361	0.361	0.361	0.505	0.577	0.650	0.722	0.794	0.939	0.939	1.155	1.443
k	min	0.470	0.595	0.711	1.690	1.690	1.690	1.690	1.690	2.067	2.067	2.190	2.440
	max	0.510	0.645	0.760	1.760	1.760	1.760	1.760	1.760	2.135	2.135	2.260	2.510

Screw Thread		d	1	1-1/8	1-1/4	1-1/2	1-5/8	1-3/4	1-7/8	2	2-1/4	2-1/2	2-3/4	3
	d		1.0000	1.1250	1.2500	1.5000	1.6250	1.7500	1.8750	2.0000	2.2500	2.5000	2.7500	3.0000
PP	UNC		8	7	7	6	0	5	0	5	5	4	4	4
s	min		1.325	1.450	1.575	1.950	2.481	2.662	2.844	3.025	3.388	3.750	4.112	4.475
	max=nominal size		1.375	1.500	1.625	2.000	2.562	2.750	2.938	3.125	3.500	3.875	4.250	4.625
e	min		1.511	1.653	1.825	2.275	2.828	3.035	3.242	3.448	3.862	4.275	4.688	5.101
	max		1.588	1.732	1.876	2.309	2.959	3.175	3.392	3.608	4.041	4.474	4.907	5.340
k	min		2.690	2.940	2.940	3.440	4.830	5.210	5.580	5.950	6.700	7.440	8.190	8.940
	max		2.760	3.010	3.010	3.510	4.910	5.290	5.670	6.040	6.800	7.550	8.310	9.060

Screw Thread		d	3-1/4	3-1/2	3-3/4	4	4-1/4	4-1/2	4-3/4	5	5-1/4	5-1/2	5-3/4	6
	d		3.2500	3.5000	3.7500	4.0000	4.2500	4.2500	4.7500	5.0000	5.2500	5.5000	5.7500	6.0000
PP	UNC		4	4	4	4	-	-	-	-	-	-	-	-
s	min		4.838	5.200	5.562	5.925	6.288	6.650	7.012	7.375	7.738	8.100	8.462	8.825
	max=nominal size		5.000	5.375	5.750	6.125	6.500	6.875	7.250	7.625	8.000	8.375	8.750	9.125
e	min		5.515	5.928	6.340	6.754	7.168	7.581	7.994	8.408	8.821	9.234	9.647	10.060
	max		5.773	6.206	6.639	7.072	7.506	7.939	8.372	8.805	9.238	9.671	10.104	10.537
k	min		9.680	10.430	11.170	11.920	12.670	13.420	14.160	14.910	15.650	16.400	17.150	17.890
	max		9.810	10.570	11.320	12.080	12.830	13.580	14.340	15.090	15.850	16.600	17.350	18.110

Alternative history

ANSI/ASME B 18.2.2 - 2010

ANSI/ASME B 18.2.2 - 2015

DIN 6334

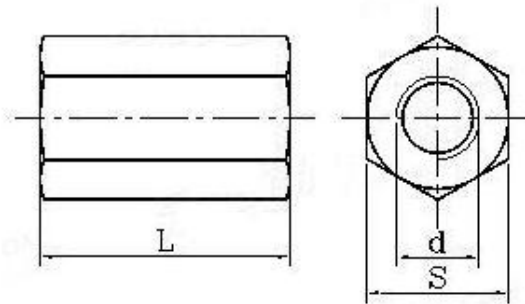

Unit: mm

Thread size	d	S	L
M6		10	18
M8		13	24
M10		17	30
M12		19	36
M14		22	42
M16		24	48
M18		27	54
M20		30	60
M22		32	66
M24		36	72
M27		41	81
M30		46	90
M36		55	108



IFI 128

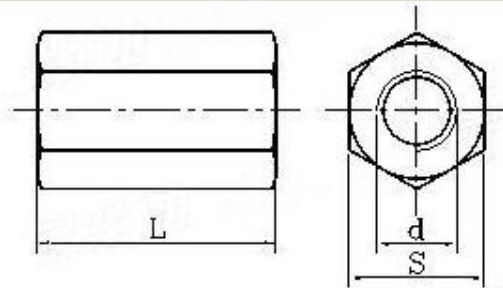

Unit: inch

d	S		L	
	max	min	max	min
1/4	0.375	0.365	0.76	0.74
5/16	0.500	0.489	0.95	0.93
3/8	0.562	0.551	1.13	1.11
7/16	0.688	0.675	1.32	1.30
1/2	0.750	0.736	1.51	1.49
9/16	0.875	0.861	1.70	1.67
5/8	0.938	0.922	1.89	1.86
3/4	1.125	1.088	2.27	2.22
7/8	1.312	1.269	2.65	2.60
1	1.500	1.450	3.03	2.97
1-1/8	1.688	1.631	3.40	3.34
1-1/4	1.875	1.812	3.78	3.71
1-3/8	2.062	1.994	4.16	4.09
1-1/2	2.250	2.175	4.54	4.46
1-5/8	2.562	2.481	4.91	4.83
1-3/4	2.750	2.662	5.29	5.21
1-7/8	2.938	2.844	5.67	5.58
2	3.125	3.025	6.04	5.95
2-1/4	3.500	3.388	6.80	6.70
2-1/2	3.875	3.750	7.55	7.44
2-3/4	4.250	4.112	8.31	8.19
3	4.625	4.475	9.06	8.94



3-1/4	5.000	4.838	9.81	9.68
3-1/2	5.375	5.200	10.57	10.43
3-3/4	5.750	5.562	11.32	11.17
4	6.125	5.925	12.08	11.92
4-1/4	6.500	6.288	12.83	12.67
4-1/2	6.875	6.650	13.58	13.42
4-3/4	7.250	7.012	14.34	14.16
5	7.625	7.375	15.09	14.91
5-1/4	8.000	7.738	15.85	15.65
5-1/2	8.375	8.100	16.60	16.40
5-3/4	8.750	8.462	17.35	17.15
6	9.125	8.825	18.11	17.89
