

## ANSI/ASME B 18.2.2

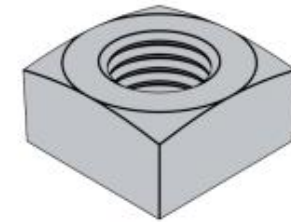

Unit: inch

Screw Thread		1/4	5/16	3/8	7/16	1/2	5/8	3/4	7/8	1	1-1/8	1-1/4	1-3/8	1-1/2
<b>d</b>		0.2500	0.3125	0.3750	0.4375	0.5000	0.6250	0.7500	0.8750	1.0000	1.1250	1.2500	1.3750	1.5000
<b>PP</b>	UNC	20	18	16	14	13	11	10	9	8	7	7	6	6
	<b>s</b>													
	min	0.425	0.547	0.606	0.728	0.788	0.969	1.088	1.269	1.450	1.631	1.812	1.994	2.175
	max	0.438	0.562	0.625	0.750	0.812	1.000	1.125	1.312	1.500	1.688	1.875	2.062	2.250
<b>e</b>	min	0.554	0.721	0.802	0.970	1.052	1.300	1.464	1.712	1.961	2.209	2.458	2.708	2.956
	max	0.619	0.795	0.884	1.061	1.149	1.414	1.591	1.856	2.121	2.386	2.652	2.917	3.182
<b>k</b>	min	0.203	0.249	0.310	0.356	0.418	0.525	0.632	0.740	0.847	0.970	1.062	1.169	1.276
	max	0.235	0.283	0.346	0.394	0.458	0.569	0.680	0.792	0.903	1.030	1.126	1.237	1.348

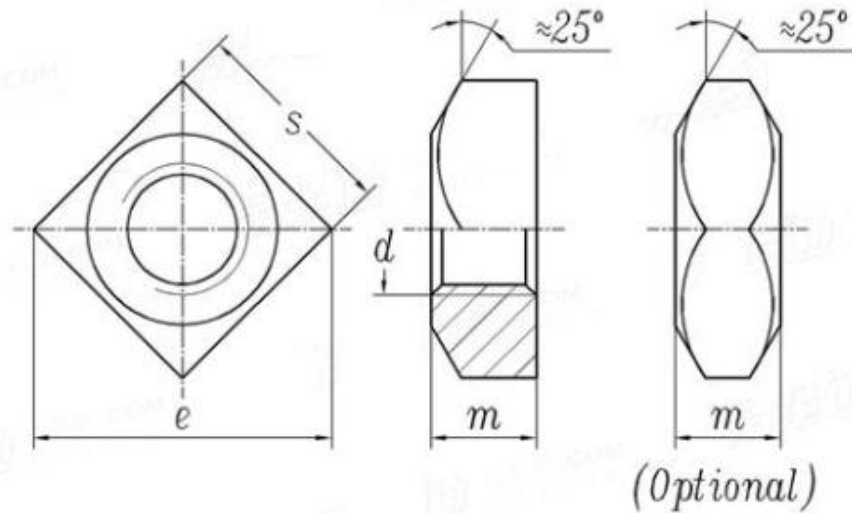
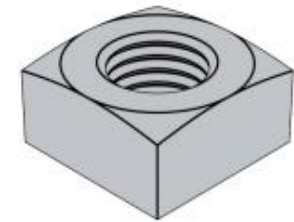
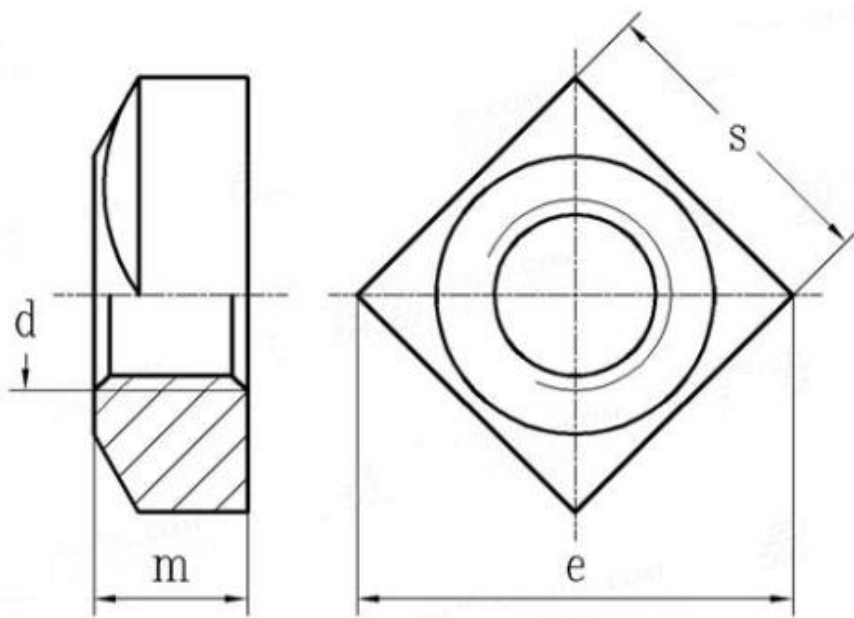

DIN 557

Unit: mm

Screw Thread		M5	M6	M8	M10	M10	M12	M12	M16
d									
P	Pitch	0.8	1	1.25	1.5	1.5	1.75	1.75	2
e	max	11.3	14.1	18.4	22.6	24	25.4	26.9	33.9
	min	9.93	12.53	16.34	20.24	21.54	22.84	24.02	30.11
m	max=nominal size	4	5	6.5	8	8	10	10	13
	min	3.52	4.52	5.92	7.42	7.42	9.42	9.42	12.3
s	max=nominal size	8	10	13	16	17	18	19	24
	min	7.64	9.64	12.57	15.57	16.57	17.57	18.48	23.16
per 1000 units ≈ kg		1.31	2.77	5.5	10.7	13	16.3	19.1	38.2

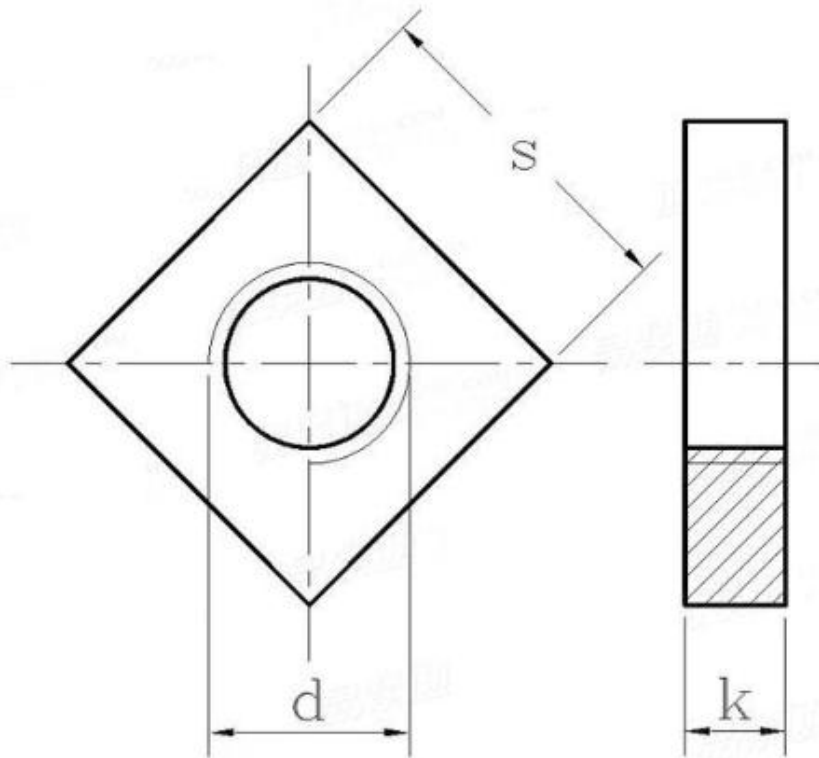

DIN 562

Unit: mm

Screw Thread <b>d</b>		<b>M1.6</b>	<b>M2</b>	<b>M2.5</b>	<b>M3</b>	<b>(M3.5)</b>	<b>M4</b>	<b>M5</b>	<b>M6</b>	<b>M8</b>	<b>M10</b>
<b>P</b>	Pitch	0.35	0.4	0.45	0.5	0.6	0.7	0.8	1	1.25	1.5
<b>k</b>	max=nominal size	1	1.2	1.6	1.8	2	2.2	2.7	3.2	4	5
	min	0.6	0.8	1.2	1.4	1.6	1.8	2.3	2.72	3.52	4.52
<b>s</b>	max=nominal size	3.2	4	5	5.5	6	7	8	10	13	16
	min	2.9	3.7	4.7	5.2	5.7	6.64	7.64	9.64	12.57	15.57
<b>per 1000 units ≈ kg</b>		0.08	0.13	0.27	0.35	0.44	0.64	1.06	1.93	4.01	7.6