

PIN ASSIGNMENT

1	LEDK
2	LEDA
3	GND
4	VDD
5	R0
6	R1
7	R2
8	R3
9	R4
10	R5
11	R6
12	R7
13	G0
14	G1
15	G2
16	G3
17	G4
18	G5
19	G6
20	G7
21	B0
22	B1
23	B2
24	B3
25	B4
26	B5
27	B6
28	B7
29	GND
30	PCLK
31	NC
32	HSYNC
33	VSYNC
34	DEN
35	NC
36	GND
37	SCL
38	SDI
39	CS
40	RESET
41	GND
42	XL
43	YD
44	XR
45	YU

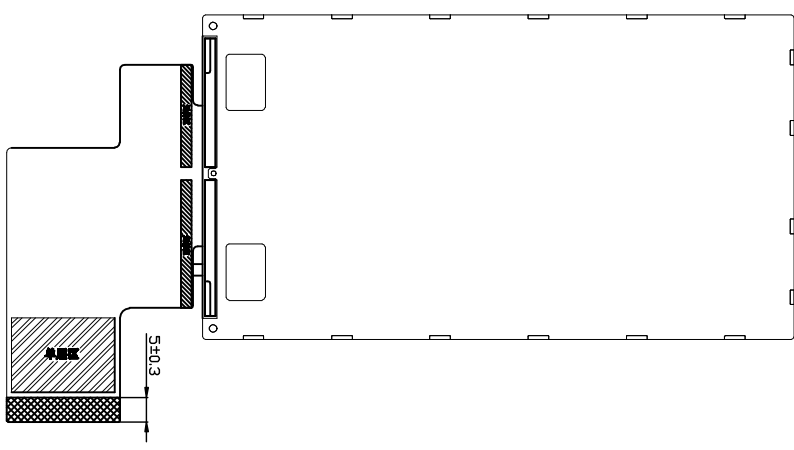

FPC 弯折示意图
弯折出货

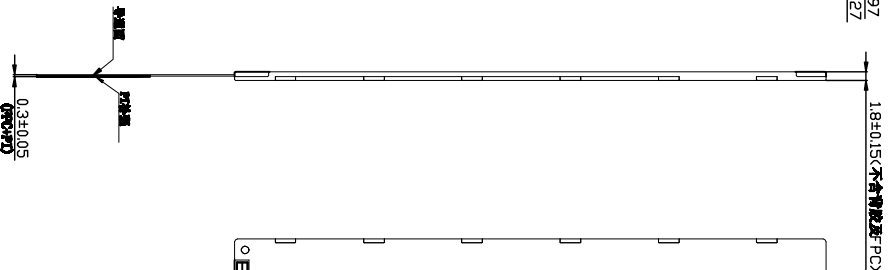
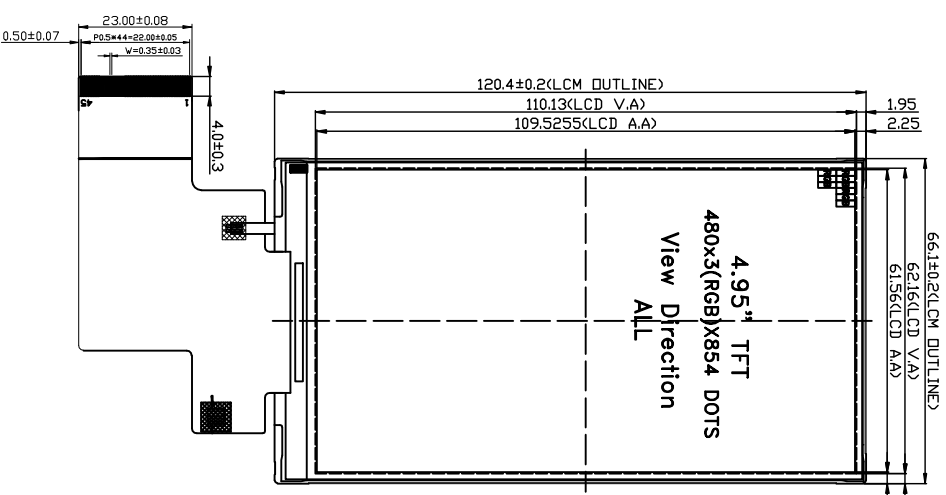
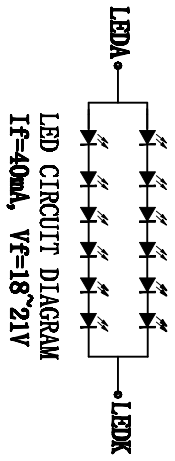
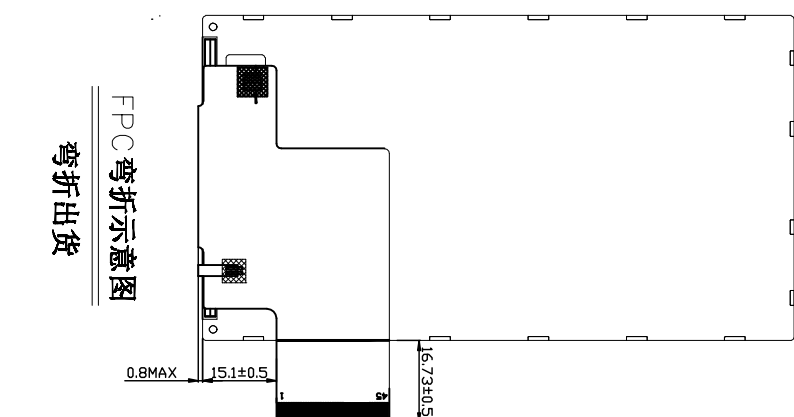

- NOTES:
1. DISPLAY TYPE: 5.0" IPS/NORMALLY BLACK
 2. VIEWING DIRECTION: 80/80/80/80 deg(U/D/L/R @ C/R>10)
 4. POLARIZER MODE: TRANSMISSIVE/NEGATIVE
 5. DRIVER IC: JD9161 or COMPATIBLE
 6. OPERATING TEMP: -20° C~+70° C
 7. STORAGE TEMP: -30° C~+80° C
 8. UNMARKER TOLERANCE: ±0.20
 9. REQUIREMENTS ON ENVIRONMENTAL PROTECTION: RoHS

REV.	CONTENT	MODEL	RXL050115-A
A	NEW	DRAWING	LQ
		CHECK	DATE
		APPROVE	DATE
		DATE	
		TOLERANCE	.X ±0.3, .XX ±0.2

RX Reshine Display (HK)
Technology Co., Limited

PAGE	1 of 1	UMIT	mm
SCALE		SIZE	A4

